

TA 256063

Figure 84. Master Cylinder, Brake Pedal Assembly, and Related Parts.
(M151, M151A1, M151A1C, and M718 only).

Oshkosh
Equipment Sales

(1) ITEM NO	(2) SMR CODE	(3) FSCM	(4) PART NUMBER	(5) DESCRIPTION AND USABLE ON CODES (UOC)	(6) QTY
GROUP 1204 HYDRAULIC BRAKE SYSTEM					
FIGURE 84 MASTER CYLINDER, BRAKE PEDAL ASSEMBLY, AND RELATED PARTS (M151, M151A1, M1515A1C, AND M718 ONLY)					
1	PAOZZ	19207	12301183	CAP,FILLER OPENING..... UOC :178,243,910,911	1
2	PAOZZ	19207	7373354	SPACER,RING..... UOC :178,243,910,911	1
3	PADOZZ	19207	10885504	PEDAL ASSEMBLY..... UOC :178,243,910,911	1
4	PADOZZ	19207	7035410	CYLINDER ASSEMBLY..... UOC :178,243,910,911	1
5	PAOZZ	19207	5214539	WASHER,FLAT..... UOC :178,243,910,911	1
6	PADOZZ	19207	8754571	CONNECTOR,MULTIPLE..... UOC :178,243,910,911	1
7	PAOZZ	19207	5160323	WASHER,FLAT..... UOC :178,243,910,911	1
8	PADOZZ	19207	5167419	BOLT,FLUID PASSAGE..... UOC :178,243,910,911	1
9	PFOZZ	19207	10885511	SUPPORT,BRAKE PEDAL..... UOC :178,243,910,911	1
10	PADOZZ	21450	425639	SCREW,ASSEMBLED..... UOC :178,243,910,911	4
11	PAOZZ	96906	MS90727-69	SCREW,CAP,HEXAGON H..... UOC :178,243,910,911	2
12	PAOZZ	96906	MS35333-42	WASHER,LOCK..... UOC :178,243,910,911	2
13	PADOZZ	19207	10885508-1	PEDAL,CONTROL..... UOC :178,243,910,911	1
14	PAOZZ	19205	10885517	BEARING,SLEEVE..... UOC :178,243,910,911	2
15	PADOZZ	96906	MS45904-72	WASHER,LOCK..... UOC :178,243,910,911	1
16	PADOZZ	96906	MS35335-34	WASHER,LOCK..... UOC :178,243,910,911	1
17	PADOZZ	96906	MS90726-38	BOLT,MACHINE..... UOC :178,243,910,911	1
18	PAOZZ	19207	7324397	BUSHING,SLEEVE..... UOC :178,243,910,911	2
19	PAOZZ	19207	8754523	SPRING,HELICAL..... UOC :178,243,910,911	1
20	PAOZZ	19207	8705443	BOLT,ECCENTRIC HEAD..... UOC :178,243,910,911	1
21	PADOZZ	19207	7017616	BUSHING,BRAKE..... UOC :178,243,910,911	2
22	PADOZZ	96906	MS27183-14	WASHER,FLAT..... UOC :178,243,910,911	1
23	PADOZZ	96906	MS51922-21	NUT,SELF-LOCKING,HE.....	1

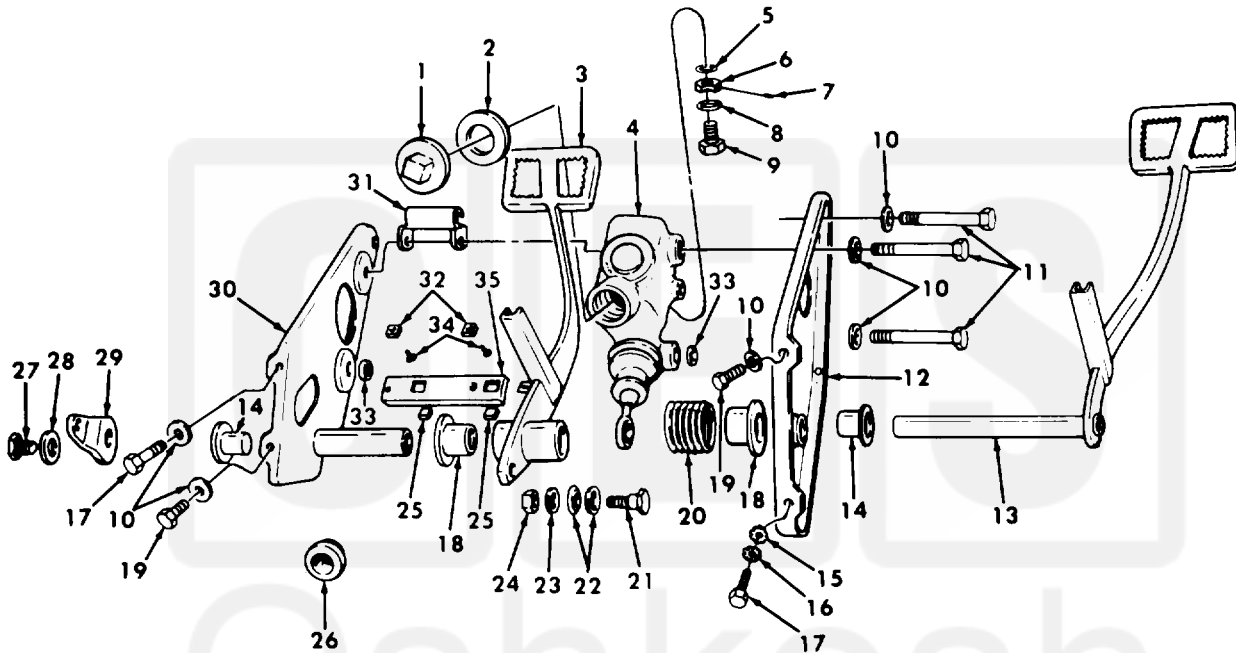

TA 256064

Figure 85. Master Cylinder, Brake Pedal Assembly, and Related Parts
(M151A2, M151A2 W/ROPS, M718A1, and M825 only).

(1) ITEM NO	(2) SMR CODE	(3) FSCM	(4) PART NUMBER	(5) DESCRIPTION AND USABLE ON CODES (UOC)	(6) QTY
GROUP 1204 HYDRAULIC BRAKE SYSTEM					
FIGURE 85 MASTER CYLINDER, BRAKE PEDAL ASSEMBLY, AND RELATED PARTS (M151A2, M151A2 W/ROPS, M718A1, AND M825 ONLY)					
1	PAOZZ	19207	12301183	CAP, FILLER OPENING..... UOC: B30, B31, B32, B33	1
2	PAOZZ	19207	7373354	SPACER, RING..... UOC: B30, B31, B32, B33	1
3	PFOZZ	19207	11660414	PEDAL ASSEMBLY..... UOC: B30, B31, B32, B33	1
4	PFOZZ	19207	7035410	CYLINDER ASSEMBLY, H..... UOC: B30, B31, B32, B33	1
5	PAOZZ	19207	5214539	WASHER, FLAT..... UOC: B30, B31, B32, B33	1
6	PAOZZ	19207	8754571	CONNECTOR, MULTIPLE..... UOC: B30, B31, B32, B33	1
7	PADZZ	15434	59118	PLUG, PIPE..... UOC: B30, B31, B32, B33	1
8	PADZZ	19207	5160323	WASHER, FLAT..... UOC: B30, B31, B32, B33	1
9	PADZZ	19207	5167419	BOLT, FLUID PASSAGE..... UOC: B30, B31, B32, B33	1
10	PADZZ	96906	MS35333-41	WASHER, LOCK..... UOC: B30, B31, B32, B33	6
11	PADZZ	96906	MS90728-45	BOLT, MACHINE..... UOC: B30, B31, B32, B33	3
12	PFOZZ	19207	11639791	SUPPORT, BRAKE PEDAL..... UOC: B30, B31, B32, B33	1
13	PADZZ	19207	10885508-1	PEDAL, CONTROL..... UOC: B30, B31, B32, B33	1
14	PADZZ	19205	10885517	BEARING, SLEEVE..... UOC: B30, B31, B32, B33	2
15	PADZZ	96906	MS45904-72	WASHER, LOCK..... UOC: B30, B31, B32, B33	1
16	PADZZ	96906	MS35335-34	WASHER, LOCK..... UOC: B30, B31, B32, B33	1
17	PADZZ	96906	MS90728-38	BOLT, MACHINE..... UOC: B30, B31, B32, B33	2
18	PADZZ	19207	7324397	BUSHING, SLEEVE..... UOC: B30, B31, B32, B33	2
19	PADZZ	96906	MS90725-31	BOLT, MACHINE..... UOC: B30, B31, B32, B33	2
20	PADZZ	19207	8754523	SPRING, HELICAL..... UOC: B30, B31, B32, B33	1
21	PADZZ	19207	8705443	BOLT, ECCENTRIC HEAD..... UOC: B30, B31, B32, B33	1
22	PADZZ	19207	7017616	BUSHING, BRAKE..... UOC: B30, B31, B32, B33	2
23	PADZZ	96906	MS27183-14	WASHER, FLAT.....	1